

MATERIAL:
 BELLOWS - MULTI-PLY STAINLESS STEEL
 HOSE AND BRAID - STAINLESS STEEL
 OTHER PARTS - CARBON STEEL

Qty.	Part Number	Size (in)	A (in)	B (in)	C (in)	Effective Area (in ²)	Spring Rate (lb/in)
	GIL04F0200	2	60-3/4	5-1/2	6-1/2	13.2	92
	GIL04F0250	2-1/2	58-7/8	5-1/2	7-1/2	13.2	92
	GIL04F0300	3	64-3/4	6-1/2	7-1/2	20.8	172
	GIL04F0400	4	64-1/2	8-1/2	9-1/2	36.0	103
	GIL04F0500	5	68-7/8	10-3/4	9-1/2	46.4	120
	GIL04F0600	6	76-3/4	12-3/4	11-3/4	58.9	138
	GIL04F0800	8	80-7/8	14	13-3/4	88.8	166

DESIGN DATA:

TEMP. 700°F. (370°C.)
 PRESS. 150 PSI (1034 KPa)
 TEST PRESS. 225 PSI (1551 KPa)

MOVEMENT 4" (100mm) ALL DIRECTIONS

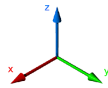

NSF 372 - LEAD FREE

The wetted surface of this product contacted by consumable water contains less than one quarter of one percent (0.25%) of lead by weight. Material complies with state codes and standards, where applicable, requiring reduced lead content.

*NOTE: ANCHOR LOADS=
 (MAX PSI X EFFECTIVE AREA)+
 (SPRING RATE X 8)

CUSTOMER: _____

PROJECT: _____

ENGINEER: _____

REV.	DATE
2323 W. HUBBARD ST. CHICAGO, IL 60612 TEL: 312-738-3800 FAX: 312-738-0415 WWW.METRAFLEX.COM	
MODEL GIL04F SEISMIC GATOR WITH FLANGED ENDS +/- 4" MOVEMENT ALL DIRECTIONS	
DRAWN BY: DTH	DATE: 11/18/2014
APPROVED:	DATE:
SCALE: NONE	DRAWING NUMBER: GIL04F

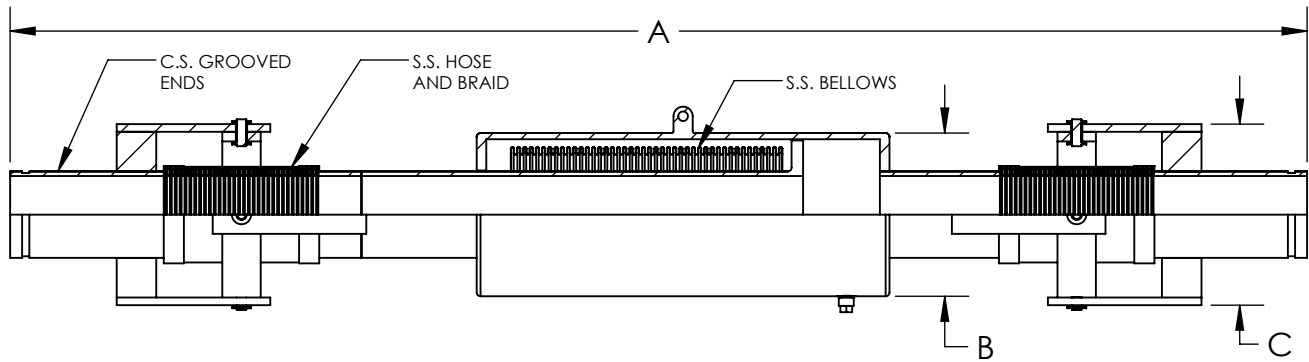
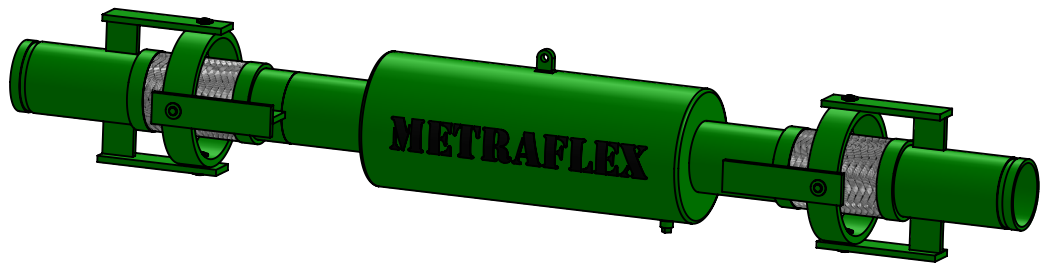

MATERIAL:
 BELLOWS - MULTI-PLY STAINLESS STEEL
 HOSE AND BRAID - STAINLESS STEEL
 OTHER PARTS - CARBON STEEL

Qty.	Part Number	Size (in)	A (in)	B (in)	C (in)	Effective Area (in ²)	Spring Rate (lb/in)
	GIL04G0200	2	60-5/8	5-1/2	6-1/2	13.2	92
	GIL04G0250	2-1/2	58-7/8	5-1/2	7-1/2	13.2	92
	GIL04G0300	3	64-5/8	6-1/2	7-1/2	20.8	172
	GIL04G0400	4	64-3/8	8-1/2	9-1/2	36.0	103
	GIL04G0500	5	68-3/4	10-3/4	9-1/2	46.4	120
	GIL04G0600	6	74-5/8	12-3/4	11-3/4	58.9	138
	GIL04G0800	8	79-3/4	14	13-3/4	88.8	166

DESIGN DATA:

TEMP. 700°F. (370°C.)
 PRESS. 150 PSI (1034 KPa)
 TEST PRESS. 225 PSI (1551 KPa)

MOVEMENT 4" (100mm) ALL DIRECTIONS

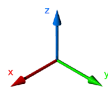

*NOTE: ANCHOR LOADS=
 (MAX PSI X EFFECTIVE AREA)+
 (SPRING RATE X 8)

CUSTOMER: _____

PROJECT: _____

ENGINEER: _____

NSF 372 - LEAD FREE

The wetted surface of this product contacted by consumable water contains less than one quarter of one percent (0.25%) of lead by weight. Material complies with state codes and standards, where applicable, requiring reduced lead content.

REV.	DATE
2323 W. HUBBARD ST. CHICAGO, IL 60612 TEL: 312-738-3800 FAX: 312-738-0415 WWW.METRAFLEX.COM	
MODEL GIL04G SEISMIC GATOR WITH GROOVED ENDS ±4" MOVEMENT ALL DIRECTIONS	
DRAWN BY: DTH	DATE: 12/16/2014
APPROVED:	DATE:
SCALE: NONE	DRAWING NUMBER: GIL04G

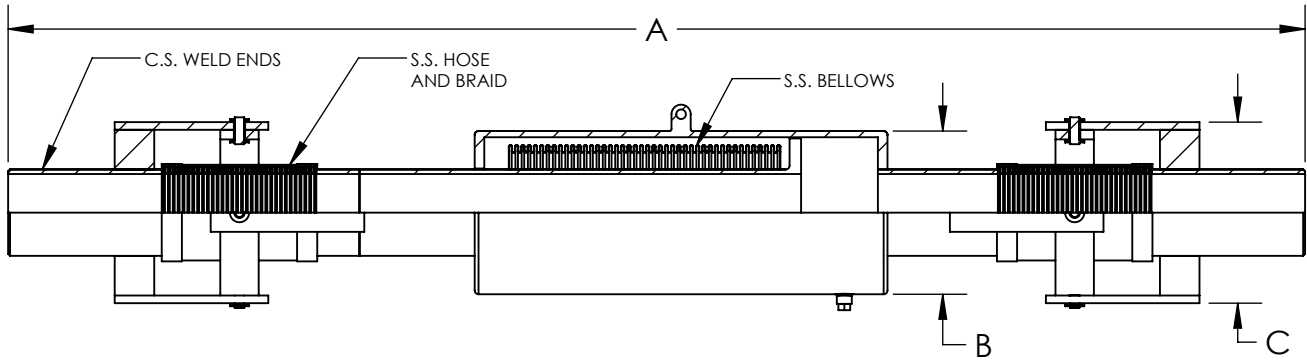

MATERIAL:
 BELLOWS - MULTI-PLY STAINLESS STEEL
 HOSE AND BRAID - STAINLESS STEEL
 OTHER PARTS - CARBON STEEL

Qty.	Part Number	Size (in)	A (in)	B (in)	C (in)	Effective Area (in ²)	Spring Rate (lb/in)
	GIL04W0200	2	60-5/8	5-1/2	6-1/2	13.2	92
	GIL04W0250	2-1/2	58-7/8	5-1/2	7-1/2	13.2	92
	GIL04W0300	3	64-5/8	6-1/2	7-1/2	20.8	172
	GIL04W0400	4	64-3/8	8-1/2	9-1/2	36.0	103
	GIL04W0500	5	68-3/4	10-3/4	9-1/2	46.4	120
	GIL04W0600	6	74-5/8	12-3/4	11-3/4	58.9	138
	GIL04W0800	8	79-3/4	14	13-3/4	88.8	166

DESIGN DATA:

TEMP. 700°F. (370°C.)
 PRESS. 150 PSI (1034 KPa)
 TEST PRESS. 225 PSI (1551 KPa)

MOVEMENT 4" (100mm) ALL DIRECTIONS

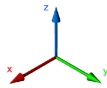

NSF 372 - LEAD FREE

The wetted surface of this product contacted by consumable water contains less than one quarter of one percent (0.25%) of lead by weight. Material complies with state codes and standards, where applicable, requiring reduced lead content.

*NOTE: ANCHOR LOADS=
 (MAX PSI X EFFECTIVE AREA)+
 (SPRING RATE X 8)

CUSTOMER: _____

PROJECT: _____

ENGINEER: _____

REV.	DATE
2323 W. HUBBARD ST. CHICAGO, IL 60612 TEL: 312-738-3800 FAX: 312-738-0415 WWW.METRAFLEX.COM	
MODEL GIL04W SEISMIC GATOR WITH WELD ENDS +4" MOVEMENT ALL DIRECTIONS	
DRAWN BY: DTH	DATE: 12/16/2014
APPROVED:	DATE:
SCALE: NONE	DRAWING NUMBER: GIL04W